



L SERIES

OPW L Series NGV1-certified fueling receptacles are designed for use on medium storage natural gas vehicles, including automobiles, light trucks, shuttle buses and vans.



Features

- ◆ **High-Flow Capacity**
The L Series receptacles have much larger flow capacity than conventional receptacles. The flow path allows very high flows, combined with low pressure drop and enhanced resistance to hydrate formation.
- ◆ **Durable, Corrosion-Resistant Construction**
All OPW receptacles are made from stainless steel.
- ◆ **Non-Contact Check Valve**
Each OPW NGV1 receptacle contains a highly reliable non-contact check valve that opens only when differential pressure is present during fueling (per NGV1 1.5.4).
- ◆ **Unique Sealing System**
The sealing system in all OPW receptacles consists of a stainless steel poppet that aligns with a rearward facing, captured seal located in the receptacle body. This arrangement prevents: seal "wash-out" during high-flow conditions and "cratering" due to debris. The seal material has exceptionally long service life, resists creep and deformation and has exceptional wear resistance under all operating pressure and temperature conditions. The poppet is treated, impact-resistant stainless steel with a polished surface to provide reliable sealing at low back pressures.
- ◆ **Bulkhead or Straight Thread**
The L Series allows the user to order a complete receptacle or buy and assemble their own adaptor shaft. They come with and without bulkhead fitting and with or without filter. The external bulkhead nut costs less than conventional stainless steel fittings.

- L Series receptacles can be used with parallel thread or compression tube fittings. L Series bodies come with either wrench flats or hex to ease vehicular mounting.
- ◆ **Filtered Receptacle (LE)**
Filters capture dirt and gas-borne debris commonly found in CNG systems. Filtered receptacles protect the receptacle seals and the vehicle fuel system. A 50-micron filter is incorporated ahead of the receptacle check valve.
- ◆ **Design Your Own Sub-System**
The OPW L Series receptacles come with the following standard features: rubber dust cap, mounting hex or wrench flats. LD and LE receptacles come with a standard external bulkhead nut.
- The bulkhead fittings allow the use of inexpensive compression tube fittings. A 50-micron filter upstream of the poppet seal is available as an option. All adaptor shafts can be purchased from OPW or from your supplier of choice.
- OPW L Series NGV1 Receptacles are designed for medium storage NGV at 200 Bar (3000 psi) or 250 Bar (3600 psi) operating pressure.
- ◆ **Rubber Dust Cap**
Standard protective dust caps are supplied with all receptacles.
- ◆ **Serviceable O-ring**
Designed to prevent leakage at the connection point.

CNG Receptacles

OPW offers a complete line of fueling receptacles for any natural gas vehicle (NGV) application. Our receptacles form part of a dedicated system designed specifically for fueling NGV.

LB

- Wrench Flats

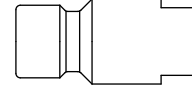

LBXX78

- 7/8 - 14 UNF - 2A

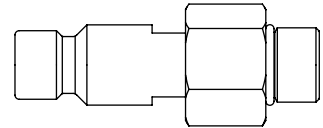

LBXX16

- 9/16 - 18 - UNF - 2A

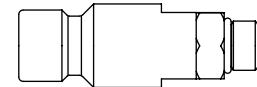

LD

- Bulk Head

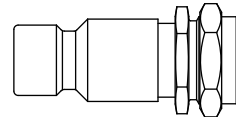

LE

- Bulk Head
- Filter

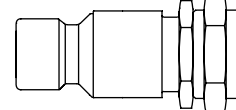

Listings and Certifications

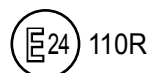



L Series NGV1 Fueling Receptacles

OPW L Series NGV1-certified Refueling Receptacles are designed for use on medium storage natural gas vehicles, including automobiles, light trucks, shuttle buses and vans.

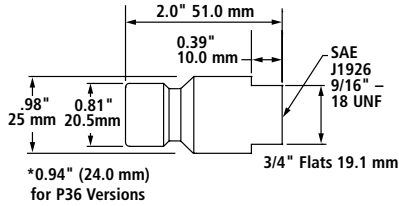

LB30 / LB36

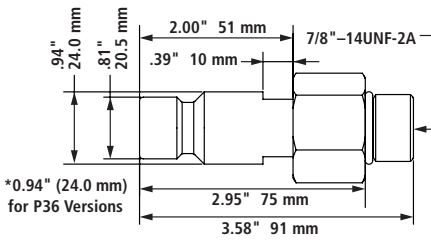

LBXX78

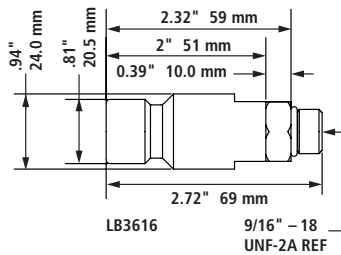

LB3616 9/16" - 18 UNF-2A REF

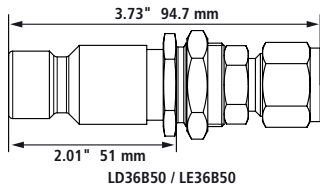

LD36B50 / LE36B50

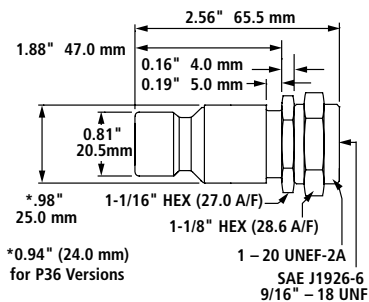

LD30 / LD36 / LE30 / LE36

Materials

- Body:** Stainless steel
- Internal Parts:** Stainless steel and brass
- Seals:** Specially formulated polymers and elastomers specific to high-pressure NGV applications.



LB30 or LB36 with stainless steel filter; 250 mesh

Features

- ◆ Protective Rubber Dust Caps - included with all OPW "L" series receptacles.
- ◆ Connects with CC200, CC300, CC600 and CT1000 Series NGV1 CNG Nozzles and BDN Defueling Nozzles.

Specifications:

- Min. Flow Rate: 1500 SCFM @ 3000 psid
- Temperature Range: -40° F to 250° F (-40° C to 120° C)
- Cv: LB = 0.91
LD = 0.85
LE = 0.83
- MAWP: 5000 psi (345 Bar)

Ordering Specifications

| Product # | Type/Size | Service Pressure | | Weight | |
|---------------|---|------------------|---------|---------|--------|
| LB30 | NGV1 Receptacle w/ 3/4" Flats, P30 | 3000 psi. | 200 bar | .31 lb. | .14 kg |
| LB36 | NGV1 Receptacle w/ 3/4" Flats, P36 | 3600 psi. | 250 bar | .31 lb. | .14 kg |
| LB3078 | LB30 + 50061 | 3000 | 200 | 0.68 | 0.31 |
| LB3678 | LB36 + 50061 | 3600 | 250 | 0.74 | 0.34 |
| LB3616 | LB36 + 50030 | 3600 | 250 | 0.42 | 0.19 |
| LD30 | NGV1 Receptacle w/ Bulkhead, P30 | 3000 psi. | 200 bar | .44 lb. | .2 kg |
| LD36 | NGV1 Receptacle w/ Bulkhead, P36 | 3600 psi. | 250 bar | .44 lb. | .2 kg |
| LD36B50 | LD36 + 212435 | 3600 psi. | 250 bar | .44 lb. | .2 kg |
| LE30 | NGV1 Receptacle w/ Bulkhead and Filter, P30 | 3000 psi. | 200 bar | .44 lb. | .2 kg |
| LE36 | NGV1 Receptacle w/ Bulkhead and Filter, P36 | 3600 psi. | 250 bar | .44 lb. | .2 kg |
| LE36B50 | LE36 + 212435 | 3600 psi. | 250 bar | .44 lb. | .2 kg |
| 1141 | Replacement "Interface" O-ring for L Series receptacles | | | | |
| 001147 | Replacement Rubber Dust Cap | | | | |
| 001147 ORANGE | Orange Color Replacement Rubber Dust Cap | NEW | | | |

Adaptor Shafts: Can be threaded into LB/LD/LE receptacles above. Materials: Stainless steel

| Adaptor Shafts P/N | Description | Weight | |
|--------------------|--|--------|------|
| | | lbs. | kg |
| 50030 | Adaptor Shaft SAE-6 (9/16" - 18 UNF - 2A) x SAE-6 (9/16" - 18 UNF - 2A) | 0.07 | 0.03 |
| 50061 | Adaptor Shaft SAE-10 (7/8" - 14 UNF - 2A) x SAE-6 (9/16" - 18 UNF - 2A) | 0.12 | 0.05 |
| 50066 | SAE-6, (9/16"x 18 UNF) to 3/8" Tube Fitting with Cap, Ferrule and Swage Ring | 0.09 | 0.04 |
| 212435 | SAE-6, (9/16"x 18 UNF) to 1/2" Tube Fitting with Cap, Ferrule and Swage Ring | 0.09 | 0.04 |

Listings and Certifications



CE 0036

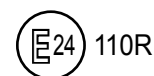



Materials

Body and Adaptor Shaft: Stainless steel

Internal Components: Stainless steel

Seals: Specially formulated polymers and elastomers specific to high-pressure NGV applications.



Features

- ◆ **High-Flow** - the flow path has been optimized to increase the amount of flow and decrease the pressure drop resulting in a reduction of noise and vibration from the check valve.
- ◆ **Durable, Corrosion-Resistant Construction** - stainless steel construction provides improved durability and corrosion resistance in the harsh on-highway, heavy-duty environment.
- ◆ **Non-Contact Check Valve** - each OPW CL series receptacle contains a highly reliable non-contact check valve that opens when differential pressure is present during refueling.
- ◆ **Sealing System** - the sealing system in all CL series receptacles consists of a stainless steel poppet that aligns with a rearward facing captured seal located in the receptacle body. This

arrangement prevents seal "wash out" during high-flow and has exceptional wear resistance under all operating pressure and temperature conditions.

- ◆ **Rubber Dust Cap** - a standard protective dust cap is supplied with CL50 series receptacles.
- ◆ **Serviceable O-ring** - designed to prevent leakage at the connection point.
- ◆ Connects to CT5000S and CC6000 series heavy-duty CNG nozzles

Specifications:

Min. Flow Rate: 5000 SCFM @ 3000 psid

Temperature Range: -40° F to 250° F
(-40° C to 120° C)

Cv: 3.30

MAWP: 5000 psi (345 bar)

Ordering Specifications

| Product # | Type/Size | Service Pressure | | Weight | |
|-----------|--|------------------|-----------|------------|----------|
| CL50 | 7/8" - 14 SAE-10 Female Port | 3600 psi. | (250 bar) | 0.91 lb. | 0.413 kg |
| CL5000 | 5/8" Double Ferrule Fitting | 3600 psi. | (250 bar) | 1.29 lbs. | 0.585 kg |
| CL5078 | CL50 + 001129 | 3600 psi. | (250 bar) | 1.141 lbs. | 0.518 kg |
| CL5016 | CL50 + 001133 | 3600 psi. | (250 bar) | 1.29 lbs. | 0.585 kg |
| CL50B50 | CL50 + 1/2" Double Ferrule Fitting | 3600 psi. | (250 bar) | 1.29 lbs. | 0.585 kg |
| 001129 | 7/8"-14 SAE-10 Male Fitting | | | | |
| 001133 | 16 mm Double Ferrule Fitting | | | | |
| 212433 | 7/8" - 14 SAE-10 to 1/2" Tube Fitting | | | | |
| 212439 | 1/2" Tube Nut and Ferrule Fitting | | | | |
| 001121 | Replacement "Interface" O-ring for CL50 Series Receptacles | | | | |
| 001126 | Replacement Rubber Dust Cap | | | | |

CL50 Series Bus/Heavy-Duty Truck Receptacles

OPW CL50 Series receptacles are designed for use on extremely high-flow, heavy-duty applications including quick-fill, self-service fueling of transit buses and large trucks.

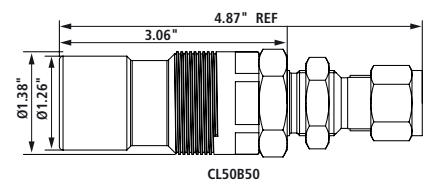
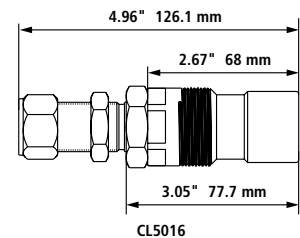
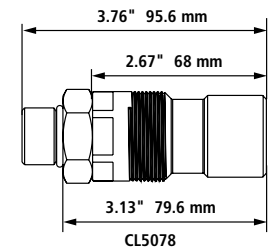
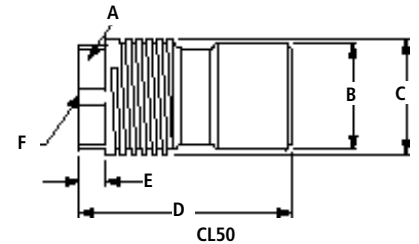

Dimensions

| CL50 | in | mm |
|------|-----------------------------|-----|
| A | 1.25 | 32 |
| B | 1.25 | 32 |
| C | 1.39 | 35 |
| D | 2.67* | 68* |
| E | 0.31 | 8 |
| F | SAE J1926-10 7/8"-14 UNF | |

*D-Dimensions for:

| | in | mm |
|---------|------|-------|
| CL5000 | 4.80 | 122.1 |
| CL5016 | 4.96 | 126.1 |
| CL5078 | 3.76 | 95.6 |
| CL50B50 | 4.87 | 123.7 |

Listings and
Certifications



CE 0036

